

Instruction Manual

使用说明书

Vertax Battery Grip E-7 For Canon 7D

电池盒兼手柄



Name of each part (部件名称)

- | | |
|--|--------------------------------|
| ① Protective cover | ① 保护盖 |
| ② Electrical contacts | ② 电子触点 |
| ③ Mounting Screw | ③ 固定螺钉 |
| ④ Guide pin | ④ 定位销 |
| ⑤ Locking ring | ⑤ 装卸旋钮 |
| ⑥ Battery magazine release handle | ⑥ 电池仓锁把手 |
| ⑦ DC cord mount | ⑦ 直流电源线插孔 |
| ⑧ AF point selection/Magnify Button | ⑧ 自动对焦点选择 / 放大按钮 |
| ⑨ AE lock/FE lock/Index/Reduce button | ⑨ 自动曝光锁 / 测曝光锁 / 索引 / 缩按钮 |
| ⑩ AF start button | ⑩ 自动对焦启动按钮 |
| ⑪ Vertical-grip operation switch | ⑪ 纵向位置操作开关 |
| ⑫ Multi function button | ⑫ 多功能按钮 |
| ⑬ Shutter button | ⑬ 快门按钮 |
| ⑭ Camera battery compartment cover slot | ⑭ 相机电池仓盖槽 |
| ⑮ Main Dial | ⑮ 主拨盘 |
| ⑯ Hand strap mount | ⑯ 手提带环 |
| ⑰ Tripod socket | ⑰ 三脚架接口 |
| ⑱ Battery Magazine BGM-E9L (for LP-E6) | ⑱ 电池夹 BGM - E9L (LP - E6 用) |
| ⑲ Battery pack compartment | ⑲ 电池仓 |
| ⑳ Battery Magazine BGM-E9A (for size-AA/LR6 batteries) | ⑳ 电池夹 BGM - E9A (AA/LR6 尺寸电池用) |

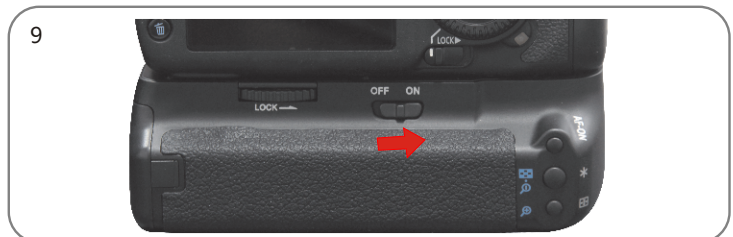
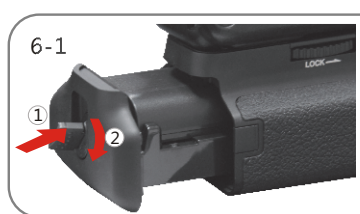
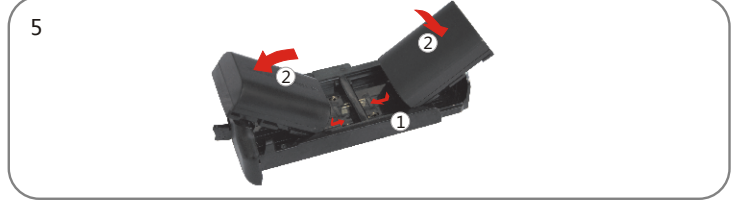
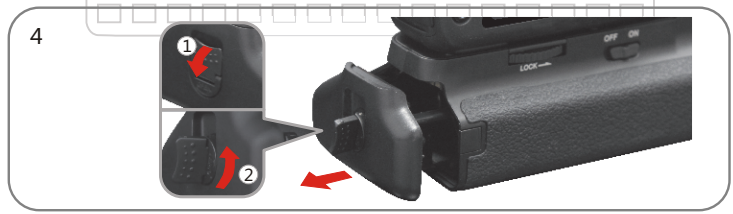
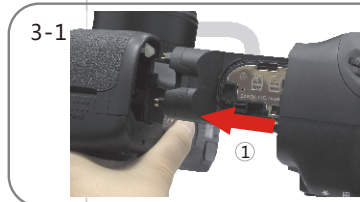
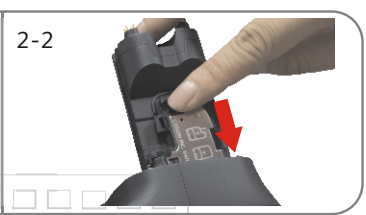
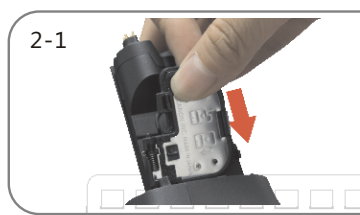

Battery Grip Vertax Instructions

Thank you for purchasing a PIXEL product.

The Vertax is a battery grip that can hold 2pcs battery LP-E6 or 6pcs size AA/LR6 batteries. It is also equipped with a vertical-grip shutter button, Main Dial, etc. to enable shooting in the same way as with horizontal grip.

Attach to the Camera

1. Remove the battery from the camera. (Fig. 1)
2. Remove the camera battery compartment cover.
3. Insert the detached cover into its storage slot to ensure that it will not be lost. (Fig. 2-1)
When taking out the cover, press lightly on the cover hinge and pull it out upward at a slanted angle. (Fig. 2-2)
4. Remove the protection cover, and then insert the electrical contacts into the camera battery compartment (Fig. 3-1)
5. Align the attachment screw with the camera's tripod socket, and then turn the attach/detach knob to tighten securely. (Fig. 3-2)

- Do not further push open the battery compartment cover when it is already opened. Doing so may damage its hinge.
- Be sure to attach the battery grip to the camera before inserting the batteries. The results of the battery check may not be displayed properly if you attach the battery grip to the camera with the batteries already inside.
- Before moving the battery grip from the camera, be sure to turn the camera's power switch to (off), and take out the batteries. After removing the batteries, attach the protective cover to the electrical contacts.

Lithium Battery Installation

1. After flipping out the release handle, turn it as shown by the arrow, and then pull out the battery magazine (BGM-E9L). (Fig. 4)
 2. Insert one or two Battery LP-E6 into the battery magazine (for LP-E6). (Fig. 5)
 3. Attach the battery magazine into the battery grip. (Fig. 6-1) After attaching, check that the battery magazine is securely attached to the battery grip.
 4. Close the release handle. (Fig. 6-2)
- If only one battery is used, it may be inserted in either the right or left side.
 - If two battery packs are inserted, power is supplied simultaneously by both batteries. Two batteries with different charging levels can be inserted and used without any problems.
 - Removing the battery packs or size - AA/LR6 batteries from the battery grip when the camera will not be used for an extended period.

AA/LR6 Battery Installation

1. Insert the batteries into the Battery Magazine BGM-E9A (for Batteries). (Fig. 7) Make sure the + and - battery contacts are properly oriented as shown in the figure.
 2. Attach the battery magazine into the battery grip. (Fig. 8-1)
 3. Close the release handle. (Fig. 8-2)
- Less images can be shot when using size-AA/LR6 batteries. Also, the number of possible shots may vary depending on the batteries brand and storage conditions, so usage of size-AA/LR6 batteries is recommended only for emergencies.
 - When using with non-rechargeable size AA/LR6 batteries, please use when temperature is above 20°C. The camera may not work when used in low temperature or when old and new batteries are used together.

Using the Battery Grip

1. Turning the vertical-grip operation switch to (ON) (Fig. 9) make the battery grip buttons and dial function in the same way as those on the camera.
2. When shooting in the horizontal-grip position, turn the vertical-grip operation switch to (OFF) so that you do not accidentally use the buttons or dial on the battery grip.
3. The battery power level can be checked on the camera.

Specifications

Battery:	1 or 2 of LP-E6 Battery, Or 6pcs AA/LR6 Alkaline Battery
Power switch:	Camera's Power Switch
Working temperature:	0°C-+40°C
Working humidity:	85% Or Less
Dimensions:	Approx. 150.1(W)x116.7(H)x84.9(D)mm
Weight:	Approx. 259.8 g (without batteries and battery magazine)

The product specifications and exterior are subjected to change without notice.

This manual information is updated at 1st Oct, 2011. If you wish to use this product combined with other Pixel products published after this date; please consult with the PIXEL dealer for further information.

Now you can start to use incredible PIXEL product. If you have any question, please contact your local dealer or visit to <http://www.pixelhk.com>

电池盒兼手柄 E-7

使用说明书

感谢你购买品色产品。

- 7 是一个可以装两个电池 LP-E6 或 6 个 AA/LR6 尺寸电池的电池盒兼手柄。本电池手柄还配有纵向位置快门按钮、主拨盘等，使你在纵向拍摄时与横向拍摄时的操作方式相同。

在使用本产品之前，请务必仔细阅读本使用说明书。

请务必妥善保管好本书，以便日后能随时查阅。

请在充分理解内容的基础上，正确使用。

安装到相机

1. 从相机中取出电池。(图 1)
 2. 卸下相机电池仓盖。
 3. 将卸下的电池仓盖插入存放区，以免丢失(图 2-1)。
取出电池仓盖时，请轻轻的按住电池仓盖的转轴，并以倾斜的角度向上将拉出。(图 2-2)
 4. 卸保护盖，然后将电子触点部插入相机电池仓。(图 3-1)
 5. 将固定螺钉与相机三脚架接孔对准，然后拧紧拆卸旋钮。(图 3-2)
- 当电池仓盖已打开时，请不要继续推开仓盖。这样做可能会损坏电池仓盖得转轴。
 - 在插入电池之前，请务必先将电池手柄安装到相机上。如果您将已装入电池的电池手柄安装到相机上，则相机可能无法正确地显示电池电量检测结果。
 - 将电池手柄从相机上卸下之前，请务必先将相机的电源开关拨到 (OFF) 位置并取出电池。取出电池后，请为电子触点安装保护盖。

安装锂电池

1. 将电池仓锁把手后，按照箭头所示反向转动，然后拉出电池夹 BGM-E9L。(图 4)
 2. 将电池夹 (LP-E6 用) 装入单个或两个电池 LP-E6。(图 5)
 3. 将电池夹装入电池手柄。(图 6)
 4. 将电池仓锁把手。(图 6 2)
- 如果只使用单个电池，可将其装在右侧或左侧。
 - 如果安装了两个电池，则两个电池同时供电。可装入两个电量不同的电池并且使用起来不会有任何问题。
 - 长时间不使用相机时，请从电池手柄中取出锂电池。

装入 AA/LR6 尺寸电池

1. 将电池装入电池夹 BGM-E9A (AA/LR6 尺寸用)。(图 7)
照图示所示，确保电池的正负触点朝向正确。
 2. 将电池夹装入电池手柄。(图 8-1)
 3. 将电池仓锁把手。(图 8-2)
- 使用 AA/LR6 尺寸电池时，能够拍摄的图像较少。此外，根据电池的品牌和存放条件，能够拍摄的图像张数可能不同，因此建议您只在紧急的情况下使用 AA/LR6 尺寸电池。
 - 利用非充电式 AA/LR6 尺寸电池时，请在 20 以上的温度下使用 6 个相同品牌的新电池。在低温条件下或新旧电池混合使用时，相机可能不工作。

使用电池手柄

1. 将纵向位置操作开关转到 (ON) 位置(图 9)使用电池手柄按钮和拨盘功能与相机相应的功能相同。
2. 在进行横向位置拍摄时，请将纵向位置开关转到 (OFF) 位置，以免不小心使用电池手柄上的按钮或拨盘。
3. 可在相机上查看电池电量。

规格

电源	1) 一个或两个电池 LP-E6 2) 6 个 AA/LR6 尺寸碱性电池
电源开关	相机的电源开关
工作温度范围	0 - +40
工作湿度范围	85 % 或更小
尺寸	约 150.1 (宽)x116.7 (高)x84.9 (厚)mm
重量	约 259.8 克 (含电池和电池夹的重量)

产品规格及外观如有变化，恕不另行通知。

说明书本的信息更新至 2011 年 10 月 01 日，如果要与此日期之后发布的产品组合使用，有关信息请向品色经销商咨询。

现在，你可以体验无与伦比的品色产品。如有任何疑问可以向当地经销商咨询，或登陆 <http://www.pixelhk.com.cn> 查询

制造商：品色(香港)企业有限公司
地址：香港九龙荔枝角青山道 704 号裕兴工业大厦 4 楼
电话：(852) 324-1188

